

# CQ Headset

By  
Card Machine Works



## User Guide



# Thank You

---

Thank you for choosing a CQ Headset by Card Machine Works. We hope you find that our products provide both exceptional comfort and communication quality, contributing to an outstanding flying experience.

The CQ Headset is a premium aviation headset for excellent cockpit communication without the need for power.

# Using your CQ Headset

---

## Control

- A. Volume control: The volume control knob adjusts the audio volume coming from the aircraft radio and intercom. This control is independent of audio from a media device via the 3.5mm input.
- B. Mono / Stereo selector switch: Set to match the aircraft headphone wiring. This switch only affects audio from the aircraft panel and not an external device.
- C. Auxiliary audio input jack: This 3.5mm connection provides for a wired external audio device input.

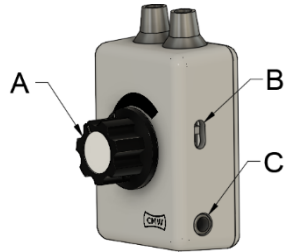

# Using your CQ Headset

---

## The Perfect Fit

The CQ Headset is pre-shaped but may benefit from some minor adjustments to be the perfect fit for your head. The size and location of the ear bend that is opposite the microphone side is just a suggestion. You can adjust the exact bend location and angle to the most comfortable fit for you. Please do not adjust the bend on the microphone side.



## Wearing the Headset

Generally, the headset is worn behind the head with the bends over the ears, a bit like glasses backwards. Alternatively, some find it more comfortable if worn a bit higher over the ears or over a hat band as this gives even more clearance with sunglasses. This may produce a more stable and secure experience by avoiding pivoting fore and aft on your ears.

## Stereo / Mono Switch

The slide switch (B) on the side of the control is used to set the CQ Headset to match the signal from your aircraft audio panel. It

## Using your CQ Headset

---

should be on the side with the 'S' stamp for stereo audio panels and the opposite side for mono audio panels (default). If you hear communications only in one ear, try sliding the switch to the other side. This switch has no effect on auxiliary audio input via the 3.5mm jack.

### Microphone Positioning

There is a white dot on the microphone. It must be positioned on the side of the microphone directed toward your lips. You can feel the orientation of the microphone element inside the muff. You will get the best performance if the flat part is facing

your lips. The foam mic muff should be just touching the front of your lips and is required to be installed for the mic to function correctly.

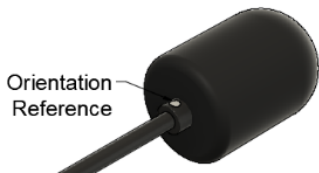

# Using your CQ Headset

---

## **Mic Gain and Balance Adjustment**

If you need to adjust the microphone gain or left/right balance, there is a small trim pot inside the control for each. Remove the two screws on the rear of the control to remove the back cover. A small flat head screwdriver is then used to carefully rotate the control labeled “Mic” for mic gain adjustment or “Bal” for left/right balance adjustment.

The Mic gain adjustment is quite sensitive. Only rotate it a few degrees at a time and test in the aircraft. Clockwise increases microphone sensitivity and counterclockwise decreases sensitivity.

## **Auxiliary Input**

The CQ Headset has a standard 3.5mm audio input jack (C) that can be used to connect an external wired audio source. Use the connected device to adjust the input volume.

## The Importance of Ear Tips

It is critical that the ear tips seal up all the open space in the ear canal to provide the best comfort and hearing protection. It is not as simple as pushing in the ear tip. Roll the foam tip between your thumb and index finger, progressively adding more pressure to compress the foam into a tight cylinder and avoid any creases. While the foam is compressed, pull up and out on your ear and insert the tip deep into the ear canal. Release your ear while holding the ear tip in your ear for a few seconds, allowing the foam tip to expand inward so that it can create a tight seal.

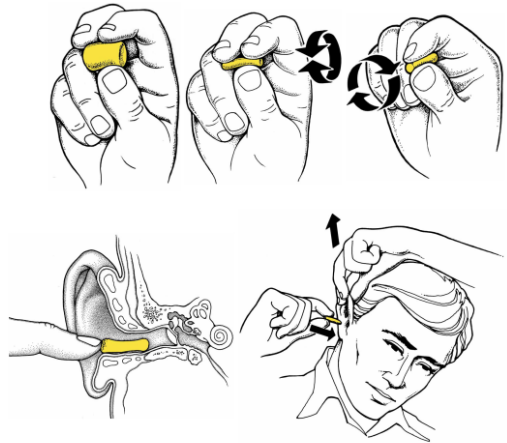



## Ear Tip Options

We supply ear tips with excellent performance and comfort. However, everyone has different ear canals and may find better performance or more comfortable ear tips elsewhere. We encourage you to experiment as ear tips are a very personal choice and everybody has a different opinion and like/dislike. Your ear canals are unique to you and your left and right may require different sizes.

Do not be afraid to try different sizes. Sometimes, smaller is better for ease of proper ear tip insertion and comfort.

## Replacement

Ear tips should be replaced regularly. They are not intended for perpetual use. Clean tips will also perform better. Sound tubes may also need replacing at some point due to internal moisture buildup causing gradual volume reduction.

## **New to In-the-ear Headsets**

If you are new to in-the-ear headsets or have had trouble getting a good seal, please view the video in the Ear Tips link at [cqheadset.com](http://cqheadset.com) for proper insertion techniques. Also, we recommend you try them on a few short flights before embarking on a long day of flying.

With a little practice, standard foam ear tips can be inserted quickly and provide excellent cockpit noise attenuation even compared to other active noise cancellation solutions.





CQHEADSET.COM (737) 529-8074